



Clearance Publish

Clearance = 100mm

REVISED
19/04/2005

Clearance Computation Specification		
Products Selected		
NSB__0009 - BARREL CALORIMETER SERVICES - IN SECTOR 1 ON SIDE C(A)	ZTB__0002 - GLOBAL TB ENVELOPE (8 COILS)	22.9
	ZAB__0001 - AB INDIVIDUAL ENVELOPE - AND LOCATION OF INTERFACES	39.2
	NLB__0002 - LB TILE CALORIMETER - SIMPLIFIED 3-D OBJECT	26.2
	NMA__0003 - BARREL PROJECTIVE ALIGNMENT. - SIMPLE 3-D MODEL. SECTOR 5	39.8
	NSB__0001 - SOLENOID CHIMNEY FOR BARREL LAR - SIMPLIFIED 3D OBJECT	11.9
	NSB__0002 - BARREL CALORIMETER CRYOGENIC LINES - SIMPLIFIED 3D OBJECTS	38.1

Results have been considered with responsible designer Peter Kulka

Summary:

Total conflicts detected - 6
Relevant conflicts - 3



Contact Publish

Contact Computation Specification	
Products Selected	
NSB__0009 - BARREL CALORIMETER SERVICES - IN SECTOR 1 ON SIDE C(A)	ZTB__0002 - GLOBAL TB ENVELOPE (8 COILS) – SIDE A

Computation Result:

NSB__0009	ZTB__0002	Clearance	22.9295	Not Relevant
-----------	-----------	-----------	---------	--------------

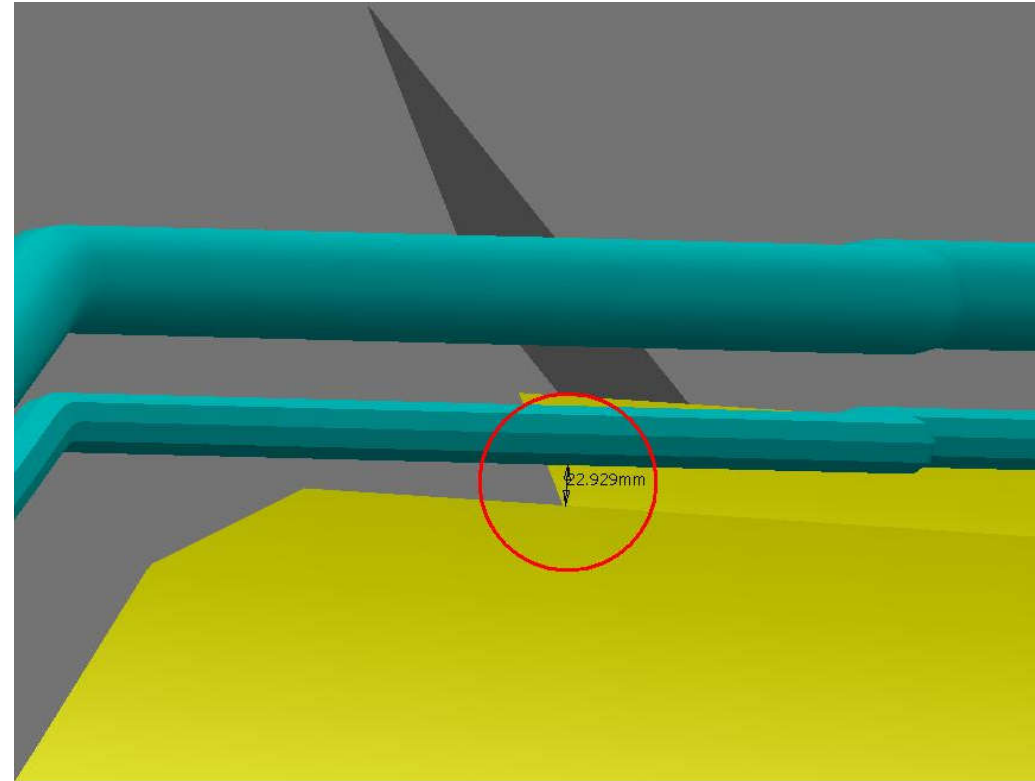
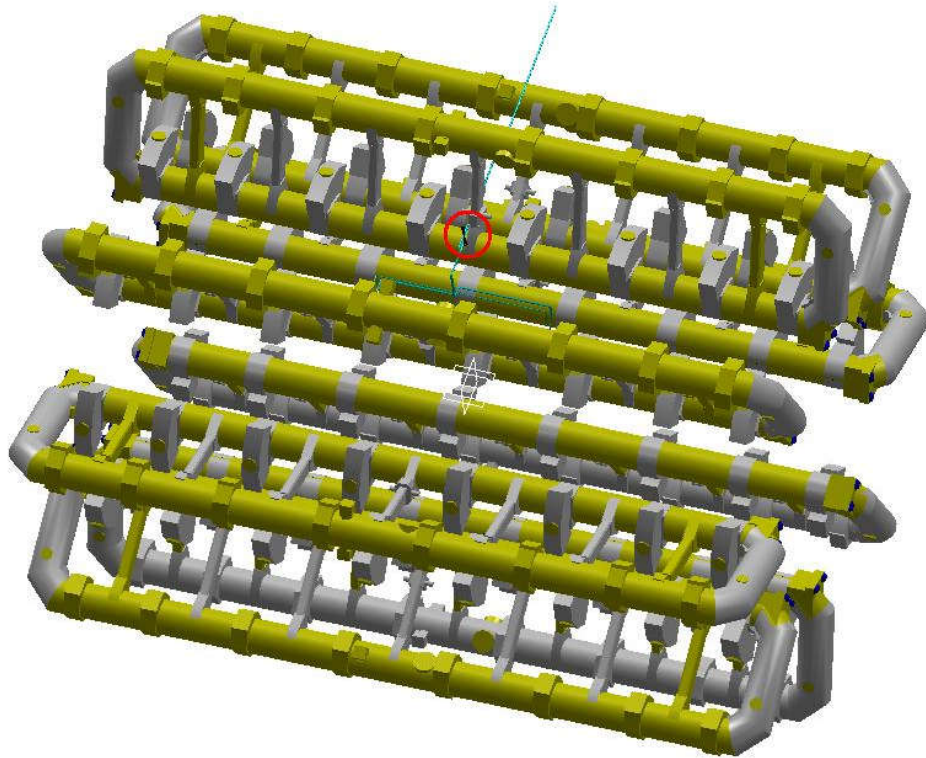

value: ~ 22.9 mm

SIDE A

Sector 6

Peter: This is the global envelope. With nominal envelope there is the distance 61mm



Clearance Publish

Clearance Computation Specification	
Products Selected	
NSB__0009 - BARREL CALORIMETER SERVICES - IN SECTOR 1 ON SIDE C(A)	ZAB__0001 - AB INDIVIDUAL ENVELOPE - AND LOCATION OF INTERFACES – SIDE A-C

Computation Result:

NSB__0009	ZAB__0001	Clearance	39.1732	Not Relevant
-----------	-----------	-----------	---------	--------------

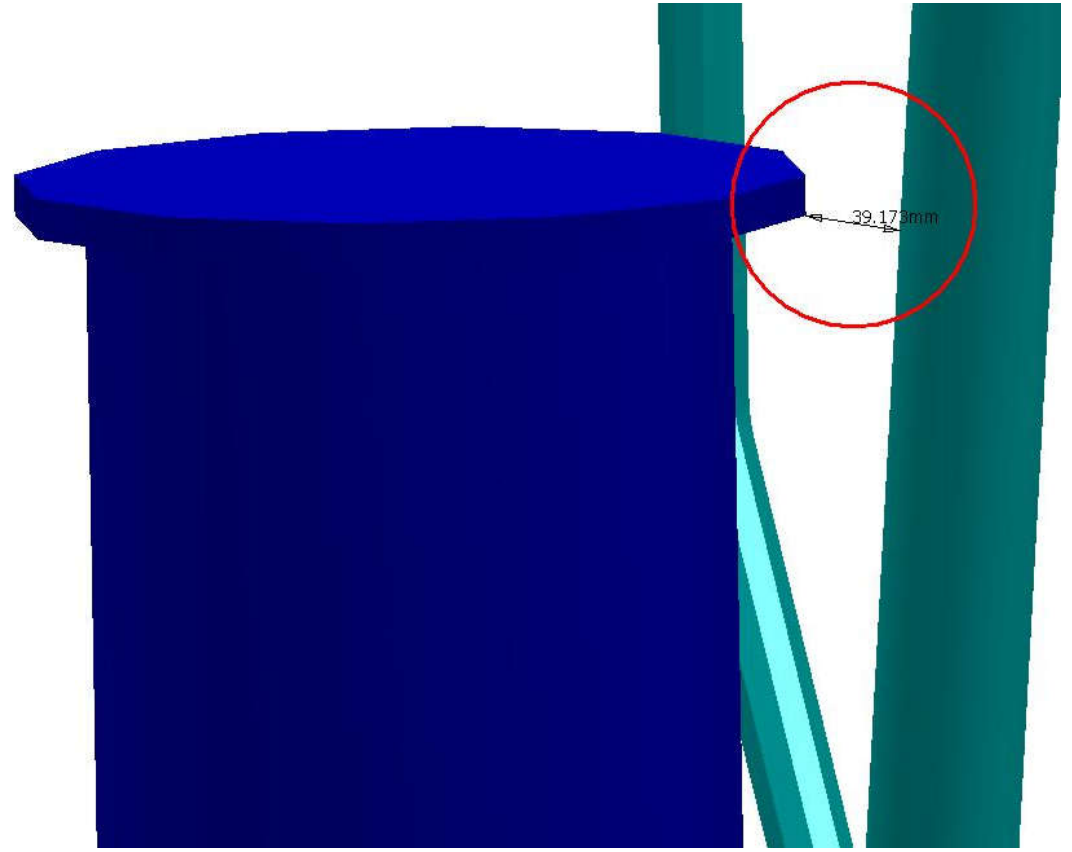
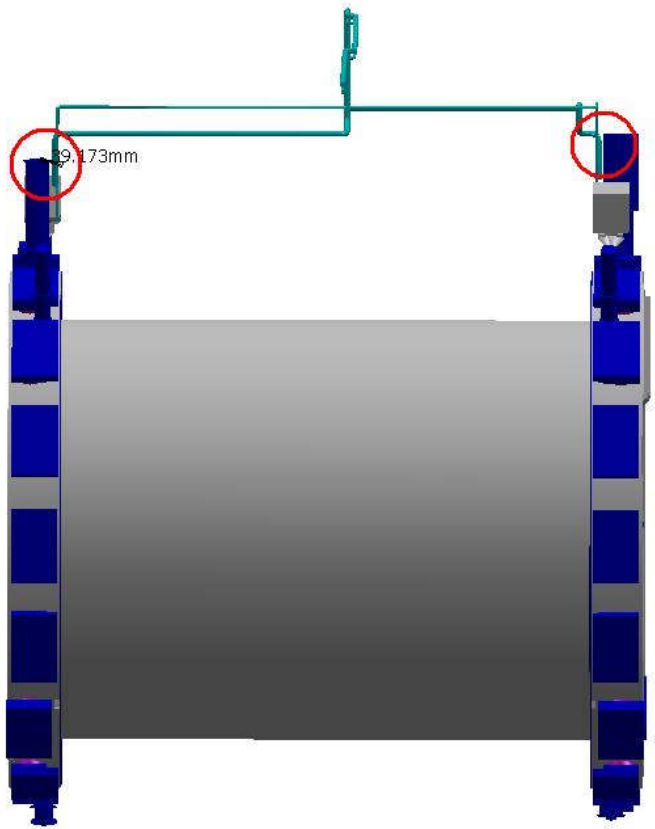

value: ~ 39.2 mm
SIDE A-C
Sector 5

Peter: This is area between LAr crates.
Part of pipes is already installed



Clearance Publish

Clearance Computation Specification	
Products Selected	
NSB__0009 - BARREL CALORIMETER SERVICES - IN SECTOR 1 ON SIDE C(A)	NLB__0002 - LB TILE CALORIMETER - SIMPLIFIED 3-D OBJECT – SIDE - A

Computation Result:

RELEVANT

NSB__0009	NLB__0002	Clearance	26.207	Relevant
-----------	-----------	-----------	--------	----------

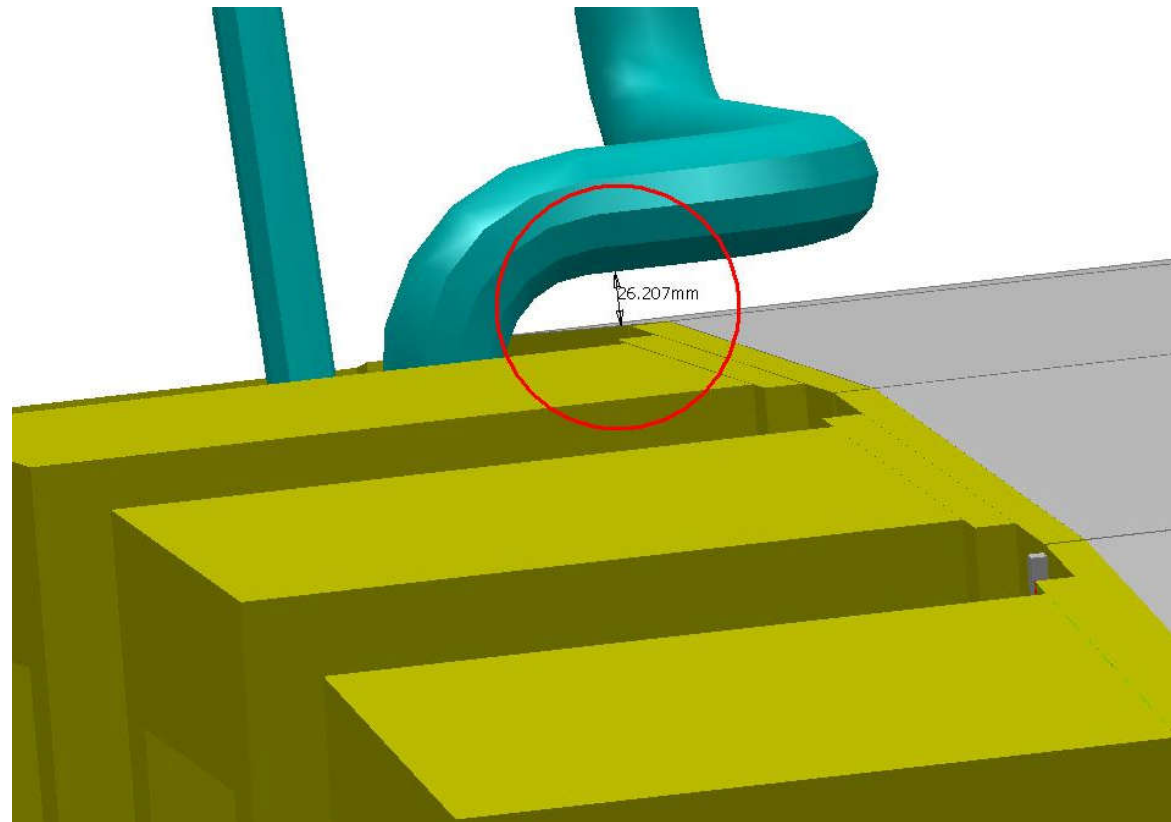
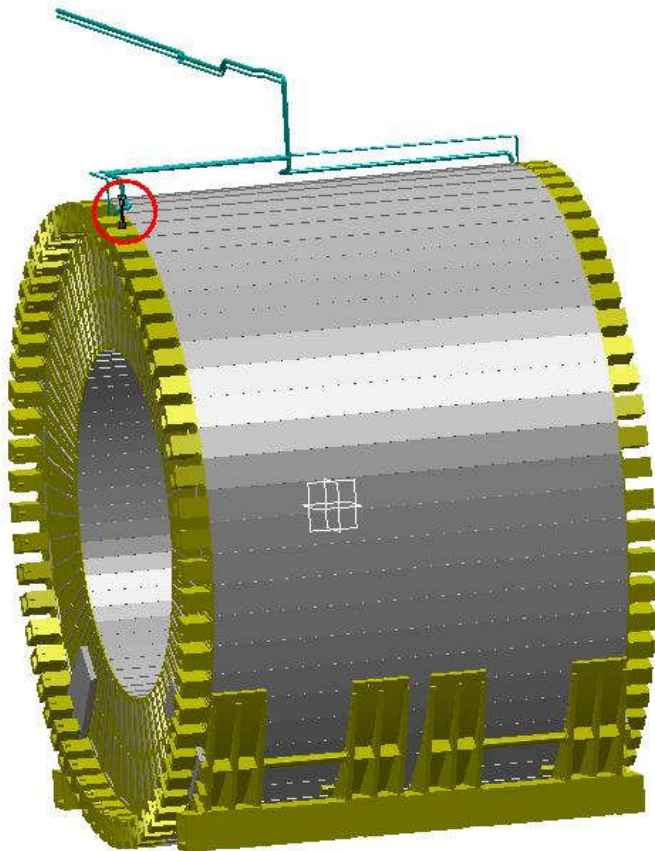

value: ~ 26.2 mm

SIDE A

Sector 5

Peter: Pipe will be fixed on Tile Calorimeter

Lasha: Peter is going to change model in order to decrease given distance up to 16mm. This will give him opportunity to increase critical distance (12mm) with NSB_0001 considered below



Clearance Publish

Clearance Computation Specification	
Products Selected	
NSB_0009 - BARREL CALORIMETER SERVICES - IN SECTOR 1 ON SIDE C(A)	NMA_0003 - BARREL PROJECTIVE ALIGNMENT. - SIMPLE 3-D MODEL. SECTOR 5 – SIDE A

Computation Result:

NSB__0009	NMA__0003	Clearance	39.8504	Relevant
-----------	-----------	-----------	---------	----------

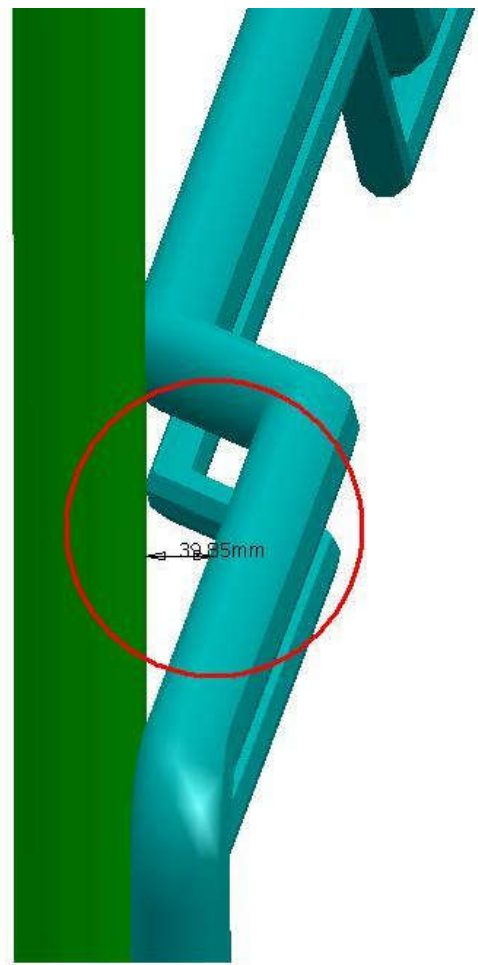
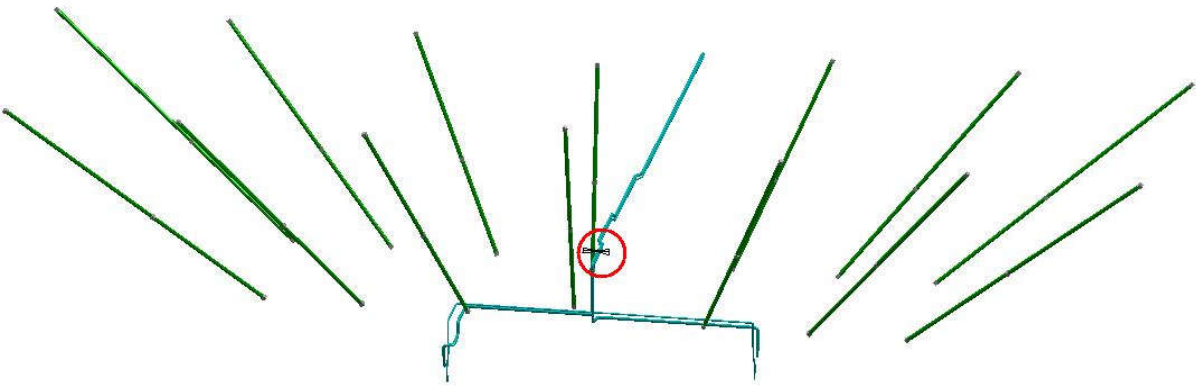

Peter: Clearance 40mm between alignment and pipe should be enough.

value: ~ 39.8 mm

SIDE A

Sector 5

Lasha: Will be considered later by Peter and others



Clearance Publish

Clearance Computation Specification	
Products Selected	
NSB__0009 - BARREL CALORIMETER SERVICES - IN SECTOR 1 ON SIDE C(A)	NSB__0001 - SOLENOID CHIMNEY FOR BARREL LAR - SIMPLIFIED 3D OBJECT – SIDE A

Computation Result:

NSB__0009	NSB__0001	Clearance	11.96	Relevant
-----------	-----------	-----------	-------	----------

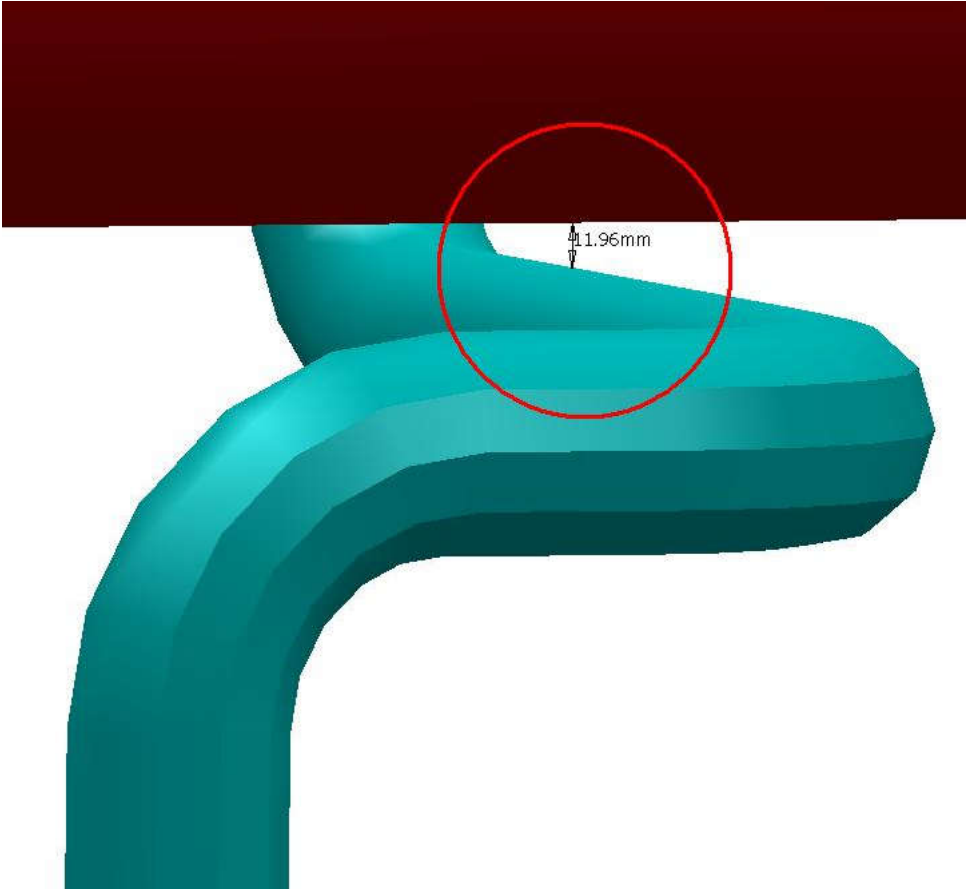
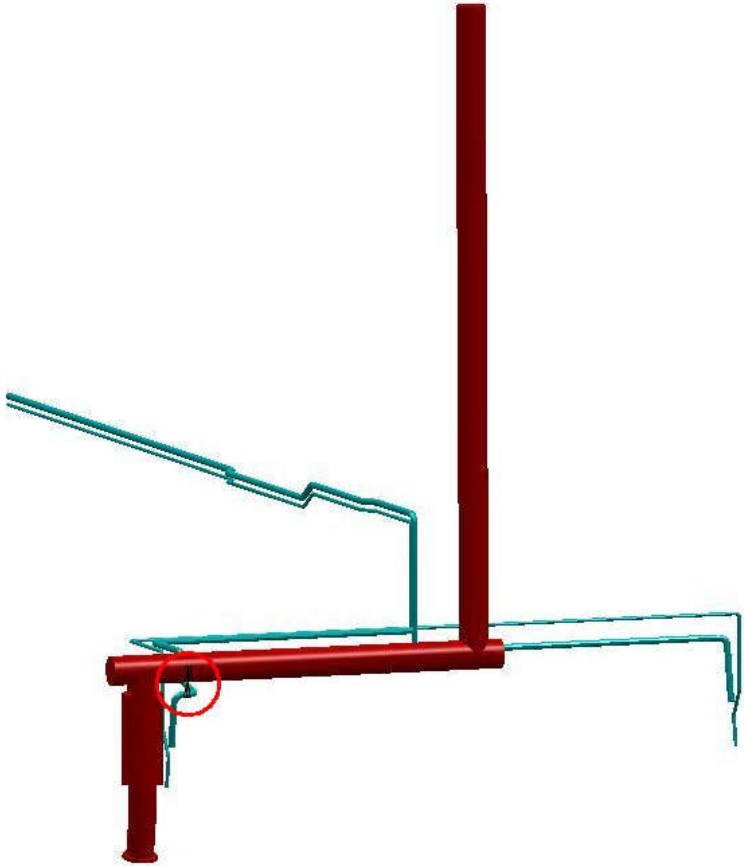

value: ~11.9 mm

SIDE A

Sector 5

Peter: Clearance looks too small. We have to take a look on it

Lasha: Model is going to be changed. So distance will be enlarged up to ~34mm



Clearance Publish

Clearance Computation Specification	
Products Selected	
NSB__0009 - BARREL CALORIMETER SERVICES - IN SECTOR 1 ON SIDE C(A)	NSB__0002 - BARREL CALORIMETER CRYOGENIC LINES - SIMPLIFIED 3D OBJECTS – SIDE C

Computation Result:

NSB__0009	NSB__0002	Clearance	38.0589	Not Relevant
-----------	-----------	-----------	---------	--------------

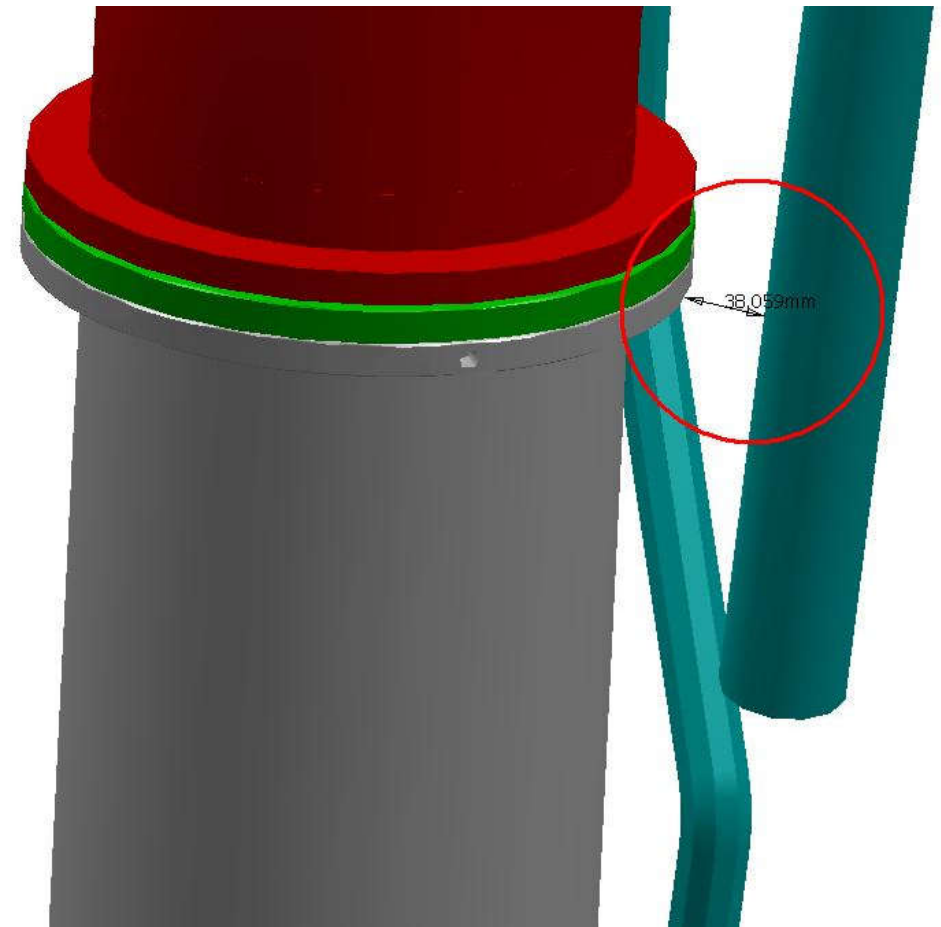
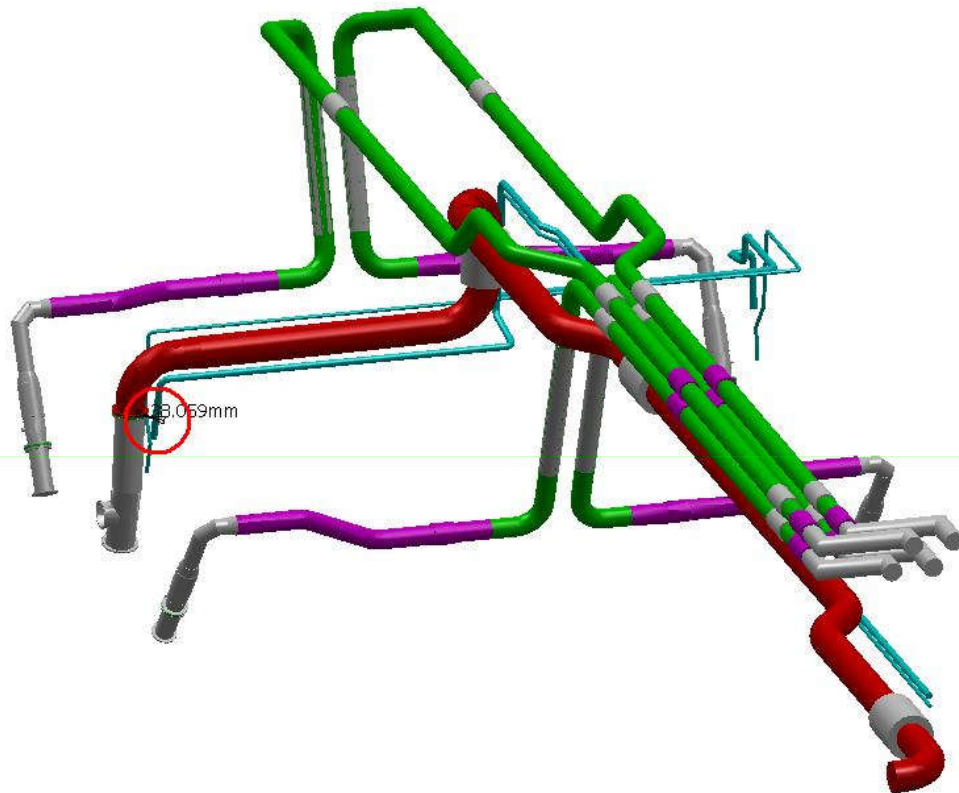

value: ~ 38.1 mm

SIDE C

Sector 5

Peter: This is area between LAr crates.
Part of pipes is already installed